

vooraanzicht

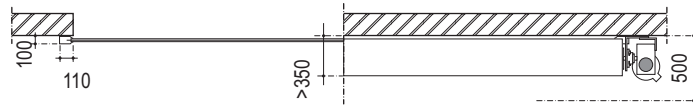

doorsnede A

doorsnede B

minimaal voor inbouw benodigd

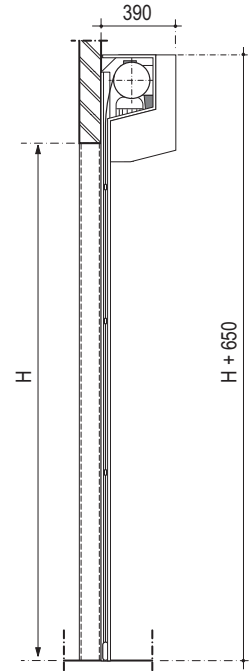
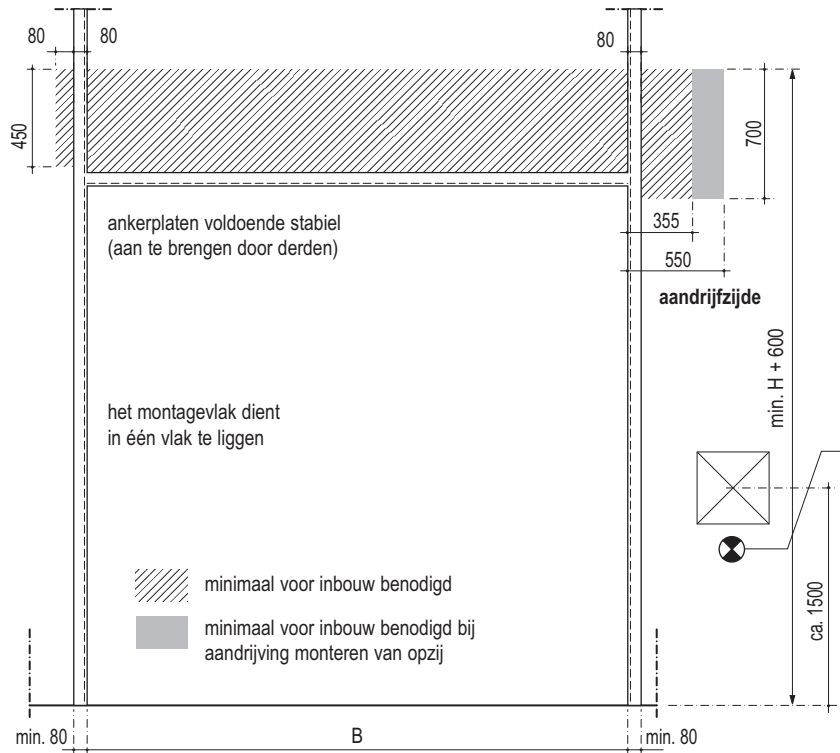

dwarsdoorsnede

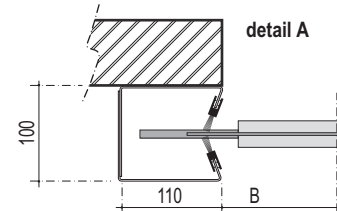

Novo Speed Basic

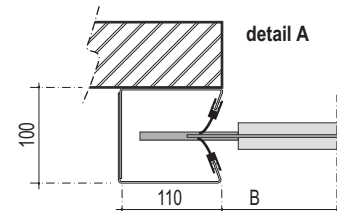

Novo Speed Basic FOOD

3-NPE/400V/50Hz/16A

stroomvoorziening te voorzien door derden

- schakelkast/ stroomtoevoer binnen RECHTS
- schakelkast/ stroomtoevoer binnen LINKS

bouwkundige voorzieningen

